

Elmsted with Hastingleigh
Community News

*St. James the Great
Elmsted*

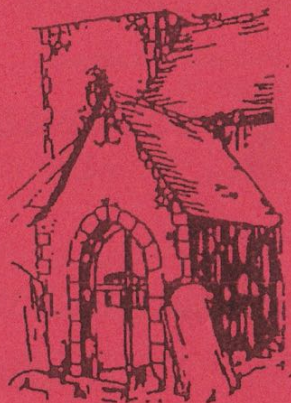

*St. Mary The Virgin
Hastingleigh*

May 2014 40p

THE UNITED WYE BENEFICE

Priest-in-charge

Rev. Ravi Holy

The Vicarage, Wye

01233 812450

Ravi.Holy@wyebenefice.org.uk

Associate Priest

(with special responsibility

For the parishes of Hastingleigh,

Elmsted, Petham & Waltham)

ST. JAMES THE GREAT, ELMSTED

Churchwarden: Mr Chris Jeffery 01233 750223

Hon. Secretary PCC: Mrs Ann Burton 01233 750430

ST. MARY THE VIRGIN, HASTINGLEIGH

Churchwarden: Mrs Roz Bacon 01233 750327

Hon. Secretary PCC: Mrs Selina Farnfield 01233 750450

PARISH WEBSITES

www.elmstedpc.kentparishes.gov.uk

www.hastingleighpc.kentparishes.gov.uk

COMMUNITY NEWS

Editor Mrs Sue Boxall 01233 750206

Quackers, The Street, Hastingleigh

Advertising Manager Mrs Alison Shepherd 01233 750072

Little Gains Cottage, TN25 5JU

Closing date for material: 15th of the month prior to publishing via

elmstedwithhastingleighnews@yahoo.co.uk

General Builders and Property Maintenance



All aspects covered



Free Estimates

Glenn Young 01233 750520
Colin Blaskett 079 6885 3556



Seasoned logs available, free local delivery

PAINTING & DECORATING

DAVID FARNFIELD

**FOR ALL YOUR DOMESTIC DECORATING
NEEDS**

INCLUDING SASH WINDOW RESTORATION

AND WALLPAPERING

FREE Estimates

Mob: 07710 130275

Tel: 01233 750450

Email: enquiries@davidfarnfield.com

www.davidfarnfield.com



Tree Work And Fencing

Contractor

- Tree surgery work undertaken: Trees shaped, reduced, or removed.
- Hedge cutting.
- Stump grinding.
- Garden fencing supplied and erected
- Hedges planted
- Composted wood chips for mulching flower beds, supplied in bulk by small tipper.
- 25 years local experience, fully insured.

Toby Gardener
Beriscot
Hastingleigh



Tel/text mob: 07831473981
Evening: 01233 750489

Email: tandrgardener@btinternet.com

Vince Martin Carpentry and Decorating

For all your Home Improvements, and Maintenance, carried out by a Local Quality Tradesman with over 30 years experience. Work on Period Property a Speciality.

Prompt reliable service and very competitive rates. Ring for a Free No Obligation Quotation.

Absolutely **NO JOB TOO SMALL**, including, Doors, Flooring, Wardrobes, Kitchens, Windows (including repairs), Shelving, Fencing, Garden Decking, Decorating (internal and external), Wall and Floor Tiling, All Internal and External Maintenance.

Ring Vince for a Free Quotation

Home: 01233 750521

Mobile: 07860 393023

Or you can email me: vmartin555@btconnect.com

Southview, The Street, Hastingleigh, Ashford, Kent. TN25 5HU.

WYNCOT KENNELS

and

CATTERY

(Hastingleigh)

**FOR COMFORT AND PEACE OF MIND
WHERE A WARM CARING ATMOSPHERE
IS ALWAYS AT HAND**

**HEATED KENNELS AND CATTERY
FULLY LICENCED, FULLY TRAINED & CARING STAFF**

SPECIAL DIETS CATERED FOR

**Set in 9 acres overlooking the picturesque Kent Downs, we have 3 large paddocks
where the dogs are individually exercised and played with**

**INSPECTION WELCOMED
(8.30 - 11.30) - (2.30 - 5.00)
7 days a week**

Phone 01233 750323 for any further details

Wye Beauty

- New! Shellac - polish lasts 2 weeks
- Laser Lipo - permanent inch loss
- Electrolysis - permanent hair removal
- Waxing - 2 types of wax available
- Aromatherapy/Swedish body massage
- Red Vein, Skin Tag and Milia treatment
- Ear Piercing
- Facials
- Microdermabrasion
- Manicures/Pedicures
- Spray Tanning - organic - no odour
- I P L hair removal
- Threading
- Hollywood lashes
- Gift Vouchers

Open Tuesdays - Fridays 8.30 - 5pm(later by appt) Thursdays till 9pm. Saturdays 9 - 4

Closed Mondays.

Guinot skincare

32 years experience. Mature staff.

29 Bridge Street, Wye. TN25 5ED

Tel: (01233) 811550

Mrs Robyn Gardener AABThC BABTAC

Chris Dryland

Property Maintenance

*Decking ~ concreting ~ sheds ~ pergolas ~ weatherboarding
Fencing ~ boundaries ~ minor electrical ~ decorating ~ guttering
small projects ~ large projects ~ emergencies
Most aspects of Household and Garden Maintenance*

References available

Also:

Tipis for hire

www.bighilltipis.co.uk

For reliable service tel. 01233 750350 or 07983 242787

e-mail chrisdryland1@gmail.com

BODSHAM HOLIDAY LETS

www.bodshamholidaylets.com

The SMITHY

Two Bedrooms
Beamed lounge with wood burner
Fully equipped Kitchen
Bathroom
Enclosed garden

The BARN

Two Bedrooms
Open lounge, diner
and kitchen
Shower room

B&B COMING SOON - SUMMER 2014

Bedroom suite with sofa, plasma TV and shower room

01233 750042/07989 584801

info@bodshamholidaylets.com

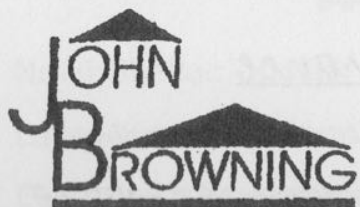

BUILDERS Ltd

Restoration & Extensions of Period Domestic Property
House Building and Conversions
Design and Planning Services

Prospect Farm House, Lees Road, Brabourne Lees, Ashford, Kent TN25 6QE

Directors: J.E. and C.M. Browning Bsc (Hons), MCIQB, MASI

Telephone: 01303 813459

VAT Registration No: 661 7887 90

THE TIMBER BATTS INN

School Lane, Bodsham, Kent TN25 5JQ

TEL:01233 750237

www.thetimberbatts.co.uk email:hello@thetimberbatts.co.uk

Closed Sunday nights, all day Monday & Tuesday Lunchtime
All well-behaved dogs are welcome at The Timber Batts

Bar Menu, Snacks Menu

Take Away available

Menu du jour

(Wed-Sat Lunch)-Two course £16.00 or three courses£20.00

Sunday Lunch menu

Two course £ 20.50 or three courses £ 25.65

A La Carte Menu available all week

2013 Magic Evenings with Etienne Pradier only at The Timber Batts

20th May, 23rd September & 18th November 2014



**Domestic
Installer
Scheme**

EDWARD YOUNG

**ELECTRICAL INSTALLATIONS &
SECURITY SYSTEMS**

Registered Electrician.

Established over 30 years.

All types of installation work carried out.

Fault finding & Repairs.

Farm - Domestic - Commercial

Telephone: 01303 813654

Mobile: 07702 640237

Imaginative design service

07715 565030

☐ From single items

01227 700883

☐ to full room plans

Christmas Cottage

☐ From budget basic

Richdore Road

☐ to dovetailed hardwood

Waltham

☐ Kitchen fitting service

Kent CT4 5SH

☐ Repairs & alterations

bengrillet@btopenworld.com



ROZ BACON

Moonraker, The Street, Hastingleigh,
Ashford, Kent TN25 5HU

01233 750327 (ans)

roz.bacon@btinternet.com

BED & BREAKFAST

Roz is a qualified Guide to the City of

Canterbury and Cathedral Guide

Delightful rooms in a lovely village

VANESSA LONDON

Mill Farm, Bodsham

01233 750427

Home Baking

Pet Sitting

Logs

LEARN FRENCH LOCALLY

Any age, any level, day or evening

Individual or small group

Helen Hewson

Tel: 01233 750589

Reena Platt

Sewing - repairs, alterations, curtains etc

Tel: 01233 650737

THE DEVIL'S KNEADING TROUGH RESTAURANT

Open 7 days a week

10.30 to 5.30 Monday — Saturday 10.30 to 6 — Sunday

(1st March - 31st October depending on weather)

10.30 to 4.30 7 days

(1st November—28th February depending on weather)

Evening Restaurant—Friday & Saturday

(Please book in advance)

Fully licensed for weddings - Coach parties welcome

Christmas Parties, Children's Parties etc. catered for

bookings@devilskneading.co.uk

Tel. No. 01233 813212

CHILHAM FEEDS



01227 731159



9am - 5pm weekdays, 9am - 1pm Saturdays

Wide variety - Friendly service - Reasonable prices - Large stocks

For Horses, Dogs, Cats, Sheep, Goats, Pigs, Poultry, Rabbits, Birds, Fish etc.

Bedding - Vitamins - Supplements - Conditioners - Accessories

East Stour Farm, A28 Godmersham, Nr Chilham, Kent

SARAH de ROUGEMONT - Craftsman/Co-ordinator

Upholstery

07973 377817

01227 455841



All commissions considered

LOCAL WINDOW CLEANER



Contact Paul Boxall

01233 750206

Style Matters design and print

Brochures, programmes, fliers
Wedding and personal stationery
Proofreading and research services
Word processing
Colour/Black and white printing, copying, scanning

Telephone: 01233 750425

Email: kerry.relton@googlemail.com
jill.relton@tesco.net

MICHAEL RUST LETTERING AND CARVING STUDIO



Sculpture and carving in wood and stone.
Architectural lettering in stone, wood and engraved glass.
Memorials and inscriptions designed and cut in the finest hands.

The Studio, Sycamore Barn, Tamley Lane
Hastingleigh, Ashford, Kent TN25 5HW

Telephone: 01233 750305

Email: michael@studiorust.co.uk www.studiorust.co.uk

EVINGTON COMMUNITY PROJECT

SPRING FAIR

Monday 5th May, 2014

On the football field, Hastingleigh

12.30



Raffle - Tombola - BBQ

Beer Tent - Teas - Cake Sale - Craft Stall

Plant Sale - Coconut Shy - Bouncy Castle

Bodsham School Merry Making Maypole Dancers

Art Exhibition in Evington Village Hall

and many more attractions



SUMMARY OF THE EVINGTON VILLAGE HALL COMMITTEE AGM

The AGM of the village hall committee was held on 19th March.

Ten members were present at the meeting. The chairman George Jessel in his report thanked all the members of the committee for their work during the year. The officers on the committee remain the same for the following year.

The main fund raising events for the year which are the Christmas Bazaar, the Trevor Wye concert and the Jumble sale were successful raising very useful funds for the hall especially with the help of match funding by Vanessa London. The chairman commented on how good it was to see the return of the Evington players to the hall. Overall the hall has been well used over the last year and it was decided to keep the rents the same. Some of the funds raised have been used for the repair of the porch, electrical work, microphones for the sound system and decoration of the kitchen.

However the concern of the committee members present was the lack of representatives from frequent users of the hall. The Evington Hall Committee is made up of members from all the groups that use the hall. These groups then become affiliated to the hall and benefit from reduced rents. It would be good to see representatives from some frequent users of the hall join the committee and attend a couple of meetings a year. The present committee consists of people who have been on the committee for many years and it would be good to see some new members with new ideas.

The committee would like to thank all the people who supported the events at the hall during the year and hope that this will continue.

ELMSTED CHURCH

LUNCHES & TEAS



Sunday 25th May, 2014

Noon - 4pm

There will be delicious home cooked lunches and an array of home baked cakes and deserts.

We will have a plant stall with strong, healthy plants for sale to cheer up your garden.

Photographic Competition

with the themes

"The Living Countryside" and "Animals in the Countryside"

All entries welcome

For further details please contact Vanessa London 01233 750427

ELMSTED CHURCH LUNCHES & TEAS

NOON – 4PM

PHOTOGRAPHIC COMPETITION

ENTRY FORM

Photos should be taken in our local area and they should reflect the subjects;

The Living Countryside

and

Animals In The Countryside

You can enter a maximum of 3 photos per person.

All photos will be displayed in Elmsted Church.

Please either leave your entries at Bodsham School, Elmsted Church or with Vanessa.

We will produce a 2015 Calendar with some of the images

ENTRY FORM

NAME; _____ AGE(IF UNDER 18) _____

PHONE NO. _____

ADDRESS; _____

EVINGTON GARDENERS

The secret gardens of 'La Serenissima' (one of the many epithets used to describe Venice) with its unique light, whether of the shimmering heat of summer or of the mists of winter, and where the ecological balance between land and water is important, was the subject of the talk at the meeting in March. Dr. Richard Goodenough opened his lecture with some lovely scene-setting photographs. There were aerial views of the city taken from the campanile of San Marco and that of San Giorgio Maggiore which gave an excellent idea of the number and size of gardens which tend to be hidden away behind high walls and are difficult to get into. Richard grouped the gardens into four types: those belonging to sacred communities, palace gardens, public and contemporary gardens. At 2.5 acres the garden of the church of the Redentore on the Giudecca is one of the biggest, dating from the 9th century, with a variety of plants including artichokes, vines, medicinal plants and olives. This contrasted with the simplicity of the box parterres of San Giorgio Maggiore and the cypress groves of the island of San Michele, the cemetery with its distinguished occupants, Diaghilev and Stravinsky.

The gardens of Venice's many palaces tend to follow the same plan with a portego leading from the entrance on the canal to the terrace, usually of a combination of marble and brick, and through to the garden proper which often has a central path and English planting - roses, and a lot of greenery and statuary. There were pictures of the Ca' d'Oro and the Ca' Rezzonico, whose wealthy owners scoured the Mediterranean for plants, with its greenness, coolness and again a lot of statuary. The pictures of some public gardens, on the other hand, showed sad signs of deterioration. Often located in the poorer parts of Venice away from the main tourist trail, such as the Papadopoli near the station or the gardens in Castello where the Biennale is held, they perhaps lack the care and investment. The highly contemporary garden of the Guggenheim museum in the Palazzo Venier showed the trademark evergreen planting, combined brick and marble terracing and an intriguing use of glass and mirrors. Our thanks go to Richard Goodenough for his excellent talk which was much enjoyed by all.

The plant sale is on 5 May at the Hastingleigh Spring Fair where there will be lovely plants supplied by Will Denne. Do all come along.

J.P.

The sunny weather has brought on many plants and this year we have had a beautiful spring for flowers. The cold wind however reminds us that we are not in summer yet. It is a good time to see where there are places for improvement and to plan for next year.

I always find bulbs are a conundrum. They have provided glorious colour this year but what do I do now they are over. The leaves are still present and can look unsightly. Do you dig the bulbs out and plant again next autumn? Do you just chop the leaves off? The leaves supply nutrients to the bulb increasing its size and hopefully producing better flowers next year. So leave the leaves on as long as is possible. If you are keen to get planting your border remember this year the fine weather has produced an early season so a frost is still possible. Have some fleece handy to cover them on cold nights. An important aspect with half hardy plants is to make sure they are growing actively and that they have not been stopped by under watering or containment in too small pots. These plants may take some time to grow and never develop fully producing few flowers.

In the vegetable garden peas, broad beans, beetroot, etc. are growing well. We have always had a problem with pea moth when growing peas so we grow "mangetout" varieties to avoid this. In the past we have used biological control which works fine if you are after peas in pods.

We regularly use biological control on our plum and apple trees to reduce maggots. This is easy to do and requires minimum effort on our part. How this works is the pheromone in the trap attracts the male moths and they are caught on a sticky surface. It never ceases to amaze me the number of male moths we catch, 100+ each year. As the male are unable to fertilize the females the eggs don't develop when laid in the fruit.

It is a good time to put up sticky traps in the greenhouse. Insects are attracted to yellow as a colour. This will reduce whitefly particularly.

SB

PLANT SALE

AT THE SPRING FAIR

Football field, Hastingsleigh

MONDAY 5th MAY

noon onwards

Lots of lovely plants supplied by

WILL DENNE

SINGING GROUP

Following the success of the Evington Community Choir in the Spring, the participants would like to try to sing more regularly under the umbrella of local charity Living Lively.

We plan a 6 week Summer term of Wednesday evenings from June 11th until July 16th, 7pm until 9ish at Evington Hall. The cost will be £25 per person, payable at the beginning of the term unless you already belong to another Living Lively singing group. This would also include an invitation to a free "Sing Lively" full day singing event for at least 300 people at the Saga Pavilion at Sandgate on Saturday July 5th.

If you think you can't sing or feel nervous about your voice, please come along and have a go, there are no auditions or solos and most of the songs are well known. Mostly it's just a lot of fun. The success of this venture is largely dependent on numbers, so do please come.

To book your place, please ring or email:

Celia Jeffrey 01233 750585 Celia@livinglively.org.uk

Robin Helmer 01233 750236 Robin.Helmer@btinternet.com

Hastingleigh with Elmsted W.I. met on Thursday 3rd of April at Evington Hall.

Eleven members attended. The minutes of the last meeting were read and agreed.

Our speakers were John and Sue Pearce, who spoke to us on the subject of 'Glenn Miller lives on'. Glenn Miller was born in 1904 in Iowa. He found a trombone in the butcher's shop he worked in when he was at school. As a result of finding this, his schoolwork suffered. He went to university but didn't complete his education there - he passed algebra but failed music! He set up his own band in the 1930s, but it wasn't successful, mainly because he was working with drunkards. His wife persuaded him to try again in 1938. His parents in law remortgaged their house to finance it, and he imposed rules and discipline in his new band. His music was played on the radio and they started selling records. In 1941, the U.S. entered World War II and some of his musicians were called up. In 1942, Glenn Miller volunteered to be a band leader in the Navy, but was rejected as he didn't have any leadership qualities. He applied to the Army and was accepted. In the summer of 1944, he flew to London to make arrangements to play in Europe with his band. He was due to play in Paris on Christmas Day. On the 15th of December his plane took off for Paris from R.A.F. Twinwood, near Bedford. The conditions were not good for flying, with heavy low cloud. The plane was never seen again. We were told about the various theories concerning the disappearance - the plane was flying in freezing conditions and didn't have any de-icer; the pilot had been disciplined previously for not being able to fly with only instruments; and they may have been flying over an area where bombs had been jettisoned. His band continued playing, with first his brother, then his nephew, as band leader. The Glenn Miller Band is still playing.

Our next meeting will be held on Thursday 1st of May when we will be going out for our Birthday meal.

Fiona Steward

The weather for the April 2014 walk was very similar to that for the April 2013 walk, glorious warm sunshine. This year, 12 walkers and 3 dogs left the hall, walked towards Evington and then across Forty Acre Field (although I guess it's much more than forty acres now) and down towards Hastingleigh Church. Before reaching the road, we turned right and walked back towards Tamley Lane and then straight across to Hastingleigh cross-roads and on to Cold Blow. From there, we headed right to Staple Lees and then back to the village via the footpath to Boundary Lane, a total of 3.5 miles. On the way we saw Celandines, Wood Anemones, Dandelions, Campions, sweet smelling Bluebells, two Buzzards, some big Bumble Bees but not a single partridge in a pear tree! The weather afforded some lovely views too - Dowles Farm & the Stone Street from Forty Acre Field and Dungeness & the Wind Farm from Cold Blow. We finished at Rayshalay for a cup of tea where much discussion took place as to whether we had seen Bugle. A quick "Google" proved that we had indeed seen Bugle, pictured below.

Join us next month when the walk will be led by Val.

RH



Wild Bugle

CHURCH SERVICES AT HASTINGLEIGH AND ELMSTED IN MAY

Sunday 4 th May	9.30am Holy Communion Cluster Service Hastingsleigh	
Sunday 11 th May	10.00am Bodsham Family Service	
Sunday 18 th May	11.00am Hastingsleigh Service (CW)	6.00pm Elmsted Evensong
Sunday 25 th May	9.30am Elmsted Holy Communion (CW)	11.00am Hastingsleigh Holy Communion (BCP) 4.00pm Sunday Teatime at Evington Hall, Hastingsleigh

Bodsham Family Service: a less formal family service for everyone. Do come and try it!

Sunday Teatime: At Sunday Teatime, we have fun, chat and explore our faith. Come for the company, the activities, the tea or the worship, or all four! All ages welcome at Evington Hall, Hastingsleigh at 4pm.

CHURCH FLOWER & CLEANING ROTA

	St. Mary's Hastingsleigh	St. James' Elmsted
May 3rd	Mrs Bacon	Mrs McFarlane
May 10th	Mrs Geering	Mrs Hewson
May 17th	Dr & Mrs Lawson	Mrs Wright
May 24th	Mrs Day	Mrs Thrupp
May 31st	Mrs Young	Mrs Browning
Jun 7th	Mrs Courtney Mrs Jerrom	Mrs Jeffrey



DATES FOR YOUR DIARY

Thurs 1st	WI Meeting (Page 20)	7.30pm
Mon 5th	SPRING FAIR (Page 13)	12.30pm
Tues 6th	Elmsted Parish Council Meeting	7.30pm
Wed 7th	Coffee Morning	10.30am
Sun 11th	Footpath Walk (Page 21)	2.00pm
Tues 13th	Hastingsleigh Parish Council Meeting	7.45pm
Sun 25th	ELMSTED CHURCH LUCHES & TEAS (Page 15 & 16)	noon
	Sunday Tea Time	4.00pm
Mon 26th	Village Breakfast (Moonraker) (Page 25)	8.30am

Note: All events in Evington Village Hall unless otherwise stated.

Parent & Todler Group meet every Tuesday - 9.30am

Mobile Library every Wednesday 10.55am - 11.20am

Art Group meet on Thursdays 9.30am - 12.30pm

MEMORIES OF EILEEN BARTLETT – (Born at The Timber Batts, then called The Prince of Wales in 1924)

Eileen has recorded many of her memories with Robin Helmer and has been recalling the detail of her life in the bakery during WWII. After leaving Bodsham School at 14 she went as a mother's help to the Ogilvies at Vigo and then at 16 years old to work in the Bakehouse (the cottage where Lesley Waters now lives) adjoining what was the village shop.

At 6 am Eileen was at work. (Mr Morris had made up the dough and had also stoked up the oven at 5 am). The dough, weighed at 2lb. 2oz, was formed into two bread shapes – 2 at a time – and put into tins to prove – (Eileen popped home for breakfast at Elmleigh) then put into the oven with a long peel (still in Lesley's house). When the loaves were ready (all brown ones) they were taken out and stacked to cool.

Eileen's father went out in a van with the bread and groceries according to the orders taken on Monday to Stowting, Hill Street, Whatsole Street, Waltham and Petham.

At times Eileen took orders on a bicycle with a large basket. Bread was 4³/₄d (about 2p today) Once the bread was taken from the oven the cakes could be cooked. During the war these went to three army barracks – at Big Combe, The Petrol Dump in Wye (Now de Havillands), and Eastwell.

Eileen worked until 10 at night with half days on Wednesday and Saturday for £3 a week. On Saturday afternoons she often cycled to Ashford with a friend to go to the pictures and to earn extra money she went to Bodsham farm to pick strawberries and recalls the agonies of picking enough lbs to earn £1 in a day!!

Congratulations on your 90th birthday Eileen.

RB

The Bowl Inn

Hastingleigh

May Bank Holiday Opening Times



Saturday 3rd May:

Midday until late

Sunday 4th May:

Midday until 9pm

Monday 5th May:

Midday until 9pm

Tuesday 6th May:

Closed

Wednesday 7th May:

5pm until 9pm

Please contact us on 01233 750354 for further enquiries

www.thebowlonline.co.uk

Village Breakfast

Monday 26th May 8.30 – 10.30
at Moonraker, Hastingleigh. Do come!

£5 for a full English breakfast. £2 for under 12.
All Profits to St Mary's, Hastingleigh.

BEING DRIVEN ROUND THE BEND

As I write this the warmer weather has arrived in our lovely part of Kent. The daffodils are on parade, primroses line the lanes and the woodland floors are carpeted with green shoots.

With this wondrous palette comes the sounds of spring and for those of us living within earshot of the Tamley Lane Chicane it's the start of the annual symphony of car horns that heralds the return of the sun.

That's right, the roads are dry so some drivers speed up as they go about the lanes and instead of using their brakes at bends they announce their arrival, like Mr Toad, with a loud "beeping".

And like the parts played by the birds in Nature's Symphony, this car-born cacophony offers a variety of tunes and moods: There's the standard "toot-toot" and the solitary "beeeep". Occasionally, a triple "beep, bee-beep" disturbs the silence but the master of this audio tomfoolery is the sounder of the "Shave and a Haircut" riff: "beep, bee-bee, beep, beep". A fellow resident of the lane often meets this fanfare with a two-syllable Anglo-Saxon reply!

Most of us, dear villager, aren't responsible for the noise pollution caused by those drivers who, taking a leaf out of Mr Toad's Book of Noisy Motoring, "poop-poop" to warn any oncoming traffic of their approach.

That is because most of us don't feel the need to disturb the birdsong and peace of our sweet corner of England by announcing our arrival to all and sundry; no more than a sane person might shout when pushing open a door to warn anyone who may be on the other side.

That is because most of us slow down. Not so the Toads. Why should they press the brake pedal when the rest of us are expected to get out of their way?

Why should they desist from disturbing those living and working nearby who have moved to a quiet place because they, believe it or not, enjoy the quiet life?

No, the Toads expect the dog walker to jump aside and the mother with the pram to scuttle to safety. Presumably they think the seven children living on Tamley Lane (five of them on the chicane) are brought up to leap over hedges at the sound of the car horn.

As for horse riders and tractors? I cannot imagine what they are expected to do when faced with a Too-fast Toad on the bend.

We all appreciate that the Highway Code states that a horn may be used to warn other road users of one's presence. However, the trick is to drive at a speed so that you can stop in the distance you can see. Because, if another car is coming with windows wound up and the radio on its occupants won't hear you coming anyway.

Here's to a safe journey and enjoy your summer.

Disturbed of Primrose Cottage

The Bowl Inn

Hastingleigh

LIVE MUSIC

WITH



ACOUSTIC DUO

BAD SIDE OF 25

Saturday 17th May, 8.30pm start

Please contact us on 01233 750354 for further enquiries

www.thebowlonline.co.uk

COUNTRY MUSIC NIGHT

Saturday 14th June 2014

8.00 pm till 11.15 pm

Doors open 7.00 pm

Evington & Hastingleigh
Village Hall
Near Ashford, Kent
TN25 5HR

Dance or listen to
The award-winning
GARRY BLACKMORE BAND

Tickets £7-00 or £7-50 at door.

Raffle & Door prize.

No bar - bring your own drinks.

To book please call 01227 701087

WYE BEAGLES GO OUT IN STYLE

The Wye Beagles formerly The Wye College Beagles, celebrated in style the last day of their final season on Saturday 22 March 2014.

There was substantial attendance from past hunt staff, college students and committee members, together with farmers, landowners, members and supporters. Considerable support was also evident from far and wide in the hunting world, including those from the West Country, Midlands, Yorkshire, Lincolnshire, Dorset, Essex, Kent, Hampshire, Wiltshire, and Sussex. Trails were laid for the hounds to follow during the afternoon, and the day concluded with a traditional beaglers hunt tea in a local village hall.

The Beagles were founded in 1947 by Sir Newton Rycroft (owner/ Master of the Dummer Beagles) and a Wye College Student, John Stevens, with the active encouragement of Dunstan Skilbeck, the then principal of Wye College.

Thereafter the pack was largely run and staffed by students of Wye College, many of whom had the rare opportunity to hunt hounds and whip in. In 2000 the pack became independent of the College and was renamed WCB The Wye Beagles when Imperial College London merged with Wye College. The students remained actively involved until the College closed in 2009.

The current team have done an amazing job to keep the pack going for as long as they have after the closure of the College and are proud that the youngest uniformed member of the hunt staff has used the experience to facilitate entry to university. This was the fundamental principle for the establishment of the Pack in 1947. It has now come to its natural end, and the hounds have been drafted to other packs to continue their purpose in life.

Sadly it now means the Wye Beagles are unable to host their annual Wye Beagles Public Dog Show, which for the past few years has supported and raised funds for the Kent Air Ambulance Trust.

The Joint Masters and Committee wish to express their thanks and appreciation to the local neighbouring communities for their interest and support towards the beagles and hunt staff over the last 67 years.

GIVE ME ONE OF THOSE PICK ME UPS, DOC!

There was a fascinating article, captured and tortured into nonsense by one of the dailies recently. The original author later put the record straight and I received it via twitter. What a brilliant source of information! I love it!

The gist of it was this. The author looked at side effects in clinical drug trials, those that a drug has to go through to prove it works and is safe. The findings were odd. Looking at statins specifically, remarkably, patients reported typical statin side effects even when given a sugar coated placebo pill. This is well documented and rather than the placebo effect it is called the nocebo effect. An article in Pain journal dealt specifically with this effect. It looked at every single placebo-controlled trial on a migraine drug (that is a trial of the new drug versus a sugar pill). They found not only were side effects on the dummy pill common but they were similar to those of the active drug. Those receiving placebo rather than an antiepileptic used in migraine reported memory problems, sleepiness and loss of appetite.

A study in 2006 sat patients in front of a revolving drum that made them nauseous and given a placebo pill. Half were told it would make them more nauseous and were found to have increased levels of stomach activity that accompanies nausea.

In 2004 600 patients were taken to an allergy clinic and given either the drug that triggered their symptoms or a dummy pill. Nearly one in three given a placebo developed itching headache and felt unwell.

Another trial looked at the impact of listing side effects on the form given at the time of consenting patients for the trial. They then compared aspirin with placebo, in three centres, two listed the side effects and one did not. There was a six-fold increase in reported side effects in those centres where patients were told the possible side effects.

So, in the modern world of informing patients of every conceivable side effect on a leaflet, are we actually inflicting harm on them given the nocebo effect is likely to cause symptoms in a third of them merely by imparting this knowledge.

The nocebo and placebo effects are really remarkable and powerful forces.

Finally, the dispensers have asked me to mention that a 48 hour period is requested for repeat prescriptions. If you phone a doctor and he does a prescription over the phone do give them a few hours to sort it out as they deal with about 5000 prescriptions a month from dispensing patients. We are happy to accept the prescription earlier than that if you want to avoid the worry of running out.

Thank you for your forbearance at what is the busiest period in general practice I can remember in 20 years. The flu-like, endless cough bug has brought most of its victims along to see us at a time when we are hurrying to squeeze all the asthma, diabetes, hypertension and COPD checks in. Illness in the normally indestructible Dr DiBiasio and my slightly less destructible self has also added pressure.

Stay well, Dr Allan Fox



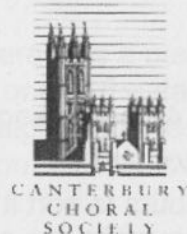

CANTERBURY CHORAL SOCIETY
CANTERBURY CATHEDRAL
Saturday 21st June 2014 7.30pm
BEETHOVEN MISSA SOLEMNIS

The Canterbury Choral Society concert on the 21st June will be very special as it will celebrate their Conductor Richard Cooke's 30th anniversary with the Society. This will be a very special occasion and made even more so by the fact that he will be conducting the Royal Philharmonic Orchestra. The RPO are based in London and was formed by Sir Thomas Beecham in 1946 and has gone on to become one of the most prestigious orchestras of its time with conductors including Vladimir Ashkenazey, Charles Mackerras and Yehudi Menuhin.

Beethoven composed Missa Solemnis for the enthronement of his great friend and pupil Archduke Rudolph as Archbishop of Olmütz – completing it three years after the enthronement ceremony. Beethoven was not a religious man – there is no anecdotal evidence of his ever having chosen to attend a church service – but in his final years he did become deeply spiritual. This work – one of only three overtly religious works in his entire output is the most representative of that spirituality. It is therefore a deeply personal expression. It was on the manuscript of this work that Beethoven wrote the words "*From the heart – may it return to the heart*".

There is nevertheless a theatricality to the *Missa Solemnis* that has led many commentators to suggest that it is more appropriate to the concert hall than the church. With four soloists and a choir, some have even suggested it should be regarded more as a short opera than anything else.

The soloists chosen by Richard for this performance all have firm roots in opera and include Sarah Fox who has sung in Wagner's *Der Ring des Nibelungen* for the Royal Opera House, Gaynor Keeble winner of the London Lieder Prize and with many Opera roles including a role in *Peter Grimes* for Aldeburgh Festival. The male soloists will be James Macdougall who is the nation's voice of classical music for BBC Radio Scotland and a regular presenter on BBC Radio 3. The bass part will be sung by Michael Pearce, a firm favourite with Canterbury audiences.

Tickets can be purchased from the Marlowe Theatre Box Office on 01227 787787 or on line at marlowetheatre.com. Visit www.canterbury.co.uk for information on the Choral Society.

In Aid of the Lord Whisky Sanctuary Fund (Registered Charity: 283483)

Park House, Stelling Minnis, Kent CT4 6AN

Tel: 01303 862622 Fax: 01303 863007

Website: www.lordwhisky.co.uk ~ Email: lord.whisky@btinternet.com

Boot & Spring Fayre

Saturday 3rd May

At Park House, Stelling Minnis

from 12 noon - 3.30pm

Hythe Town Concert Band ~ Layla Belly Dancing ~ Hawkinge Flyers

Hot & Cold Refreshments ~ Raffles ~ Tombolas & more!

Boots from 8am ~ Cars £6.50/Vans £10

Cyclo-Sportive

Bank Holiday Monday 26th May

Challenge yourself to cycle either 50 or 72 miles.

Start and finish at Park House. Feed stations en route.

Entry fee £15 in advance or £20 on the day.

Email nickracingsnake@btinternet.com for an entry form

Next Event: Dog & Owner's Fun Day, Saturday 14th June

applause
Outdoors

Periplum: The Imaginarium

Enter into the Imaginarium and unlock secret stories from Wonderland. Inspired by Alice in Wonderland and Through the Looking Glass, you will be shrunk to the size of a hedgehog, become a croquet ball and stir up a storm in a teapot!

This performance is part of Applause Outdoors



**'A MIDSUMMER NIGHT'S DREAM'
OPEN-AIR SHAKESPEARE**

Fri 27th & Sat 28th June 7.15pm

Thurs 3rd Fri 4th & Sat 5th July 7.15pm

Gardens open from 5.30pm

Sun 29th June 6pm (gardens open from 4.30pm)

Join the cast of **Actors, Singers, Dancers, Musicians,**

Please call us to **AUDITION**

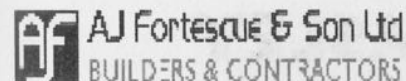

NEW BUILD, EXTENSIONS,

ALTERATIONS,

REPAIRS, GROUNDWORK

Waterside Farm, West Brabourne,

Ashford, TN25 5NA

Tel 01303 813108

E-Mail: office@ajfortescueandson.co.uk

COUNSELLING SERVICES

Bev Russell DipCouns

MBACP

brcounselling@yahoo.co.uk

www.brcounselling.co.uk

07505 749643

ALL CREATURES GREAT AND SMALL

House and pet sitting service

01233 714682 - 07942 045286

CRB Checked

Dawn Busby

Insured

Good References available

save £££s on
skip hire



- 4, 6, 8 & 12yd Skips
- Permits Arranged
- Domestic & Commercial
- Competitive Rates
- Same Day Delivery / Collection
- Committed to Recycling



Call us today on **01622 611931**

www.countrystyleskips.co.uk

RICHARD GILBERT PLUMBING & CENTRAL HEATING
Established 25 years

Oil & Gas Central Heating Specialist – OFTEC & Gas Safe Registered –
Landlord's Gas Safety Certificates.

Wood Burning Stove Installations - HECTAS registered

Full central heating installations and systems updates, oil boiler and oil
tank installation and replacement, gas boilers, fires, cookers and hobs.
Chimney sweeping and Flue Liner installations.

All Domestic Plumbing including – Power flushing, unvented hot water
systems, bathroom and showers including tiling, hot water cylinders, water
softeners, sink, dishwasher and washing machine installations, replace-
ment radiators and thermostatic valves.

Telephone 01233812566

Mobile 07860 877836

MARY HEMSLEY

INTERIORS

"the complete service"

- Curtains
- Designer fabrics
- Tracks and Poles
- Blinds
- Wallpapers
- Upholstery

Little Greene Paint

design ideas and advice

01233 813717

150 Bridge Street, Wye, Ashford, Kent. TN25 5DP



YOGA CLASSES

WALTHAM VILLAGE HALL

ON MONDAY EVENINGS

*Suitable for absolute beginners to experienced students;
men or women and a wide range of fitness levels.*

Yoga will help with flexibility, stretching, relaxation and stress.

I ALSO OFFER A VARIETY OF MASSAGE TREATMENTS

to ease stiff joints, promote health and well being and for stress management.

(Fully qualified-ITEC/LCIC/Diploma in Yoga Teaching/Life Coach)

Phone or email for more information: Lynn 01227 700071/07913305175

lynn@saxby4.orangehome.co.uk

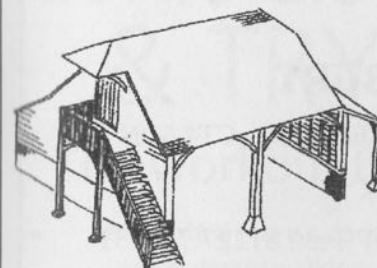

Building and Renovation,

Houses, Garages, Conventional or Oak framed, Conservatories & Sun-rooms, Renovations, Extensions & Roofs. Design & Build, or built to your own plans.

Locally based, long established small company using trustworthy local craftsmen.

Michael Barnes

Tel 01233 812555 or 07740 870540

BOSSINGHAM

GROUNDWORK & LANDSCAPING

EXCAVATION
CONCRETING
DRAINAGE
CAR PARKS
DRIVEWAYS
BRICKWORK



PATIOS
PONDS
TURFING
FENCING
PLAYGROUNDS
EQUESTRIAN ARENAS

M: 07894 007 660

W: 01303 890 704

WWW.BOSSINGHAMGROUNDWORKS.COM

ELIZABETH MILLER MSSCh MBChA

Chiropodist



TEL.
01233 750200

Home visits by appointment

**SIX MILE GARAGE
AND
FIX AUTO CANTERBURY**

STONE STREET, STELLING MINNIS, CANTERBURY, CT4 6DN

www.sixmilegarage.co.uk

Telephone: Stelling Minnis 01227 709214/491 Fax: 01227 709331

- * Service and Repairs to Cars and Light Commercial Vehicles
- * Class 4 and 7 M.O.T Testing
- * Diagnostic Tuning Centre
- * Fix Auto Body Repair Centre
- * Car Sales
- * Collection & Delivery

Forecourt Petrol & Shop

Open 7 Days a Week

**G.A. WATTS
Electrical Installations
Approved Electrician**

NICEIC DOMESTIC INSTALLER

New installations. Extra points. Complete rewires.
Appliance testing and electrical surveys.

Security lighting.
Specialist in sympathetic
Wiring for period properties.

For personal attention
And free estimates
(01227) 709376
(07973) 480241

come along
& TRY...



The workout that tones the whole body!

- Burns 46% more calories than ordinary walking
- Increase your energy levels
- Tone up and loose weight
- Easy on the knees and joints
- Suitable for all levels
- Great for neck, shoulder and back problems
- Sociable, safe outdoor exercise

Free tasters in Hastingleigh & Kennington

Call for more details on
0845 468 0899

www.nordicwalkingeastkent.co.uk

**TOP QUALITY
TUFTED TWIST CARPET
UNDER £20
INCLUDING FITTING
SELECTATWIST**



80% PURE NEW BRITISH WOOL
ONLY £19.95SQM

CARPETS *direct*

01233 714999

Selecta House, Charing Hill TN27 0NL
www.carpetdirectcharing.co.uk

Hardwood & Laminate
Showroom
Now Open

S.C.S.

Cesspool / Septic Tank Emptying Service

For That Quality Service

Southern Cesspool Services



All Types of Tanks Emptied

*Septic Tanks/Cesspool Tanks/
Treatment Plants*

*High Pressure Jetting of Drains
Soakaways ETC*



Regular Automatic Bookings



01233 646767 / 07773 491356



Card Payment Accepted



Web: www.southerncesspoolservices.com

Email: info@southerncesspoolservices.com

LOGS & FIREWOOD

**For Good Quality, Seasoned
Burning Wood**



**Ash or mixed logs (dry)
cut to order**

Ring John Austen

(01227) 700570

AFB ELECTRICAL LIMITED

Electrical Contractor



All electrical work undertaken

Please contact:

Andy Burchell

Tel: 01233 632424

Mobile: 07739 259953

E-mail: aburchell@afbelectrical.co.uk

Containerised Storage

available locally

Fully secure

Indoors or outdoors

Competitive rates

**Please phone 01233 812237 for further
details**



Bossingham pre-school

- Children aged 2-5 years
- Experienced & friendly staff
- Quiet rural location
- Breakfast & after-school clubs

Situated in purpose-built premises, within the grounds of Stelling Minnis Primary School, we offer creative and stimulating activities to help the physical, social and educational needs of every child. There's an all-weather outdoor play area, optional breakfast club available from 8am and after-school club available until 6pm.

visit: bossinghampreschool.co.uk
or call: **01227 709156**

aldingtonosteopathy

The Surgery, Goldwell Close, Aldington, Ashford, Kent. TN25 7DY.

Can provide effective treatment for many conditions including:

- | | |
|--------------------|-----------------|
| Back and neck pain | Sports injuries |
| Headaches | Trapped nerves |
| Arthritis | Shoulder pain |
| Sclatica | Whiplash |
| Knee problems | Ligament sprain |

Also available specialist osteopathic clinics for:

Pregnancy related conditions

Cranial osteopathy for babies

01233 720160

www.aldingtonosteopathy.com

LOCAL ORGANISATIONS

Elmsted Parish Council	Clerk	Tracey Block 01233 750415
Hastingleigh Parish Council	Clerk	Tracey Block 01233 750415
Evington Hall (caretaker & bookings) (Treestumps, Elmsted)		Mrs Avis Ball 01233 750231
Evington Hall Committee	Hon Sec	Mrs S Lawson 01233 750288
Evington Community Project	Hon Sec	Mr D Farnfield 01233 750450
Evington Gardeners' Society	Hon Sec	Mrs J Pearce 01233 750382
Evington Players	Hon Sec	Mrs C Batcheller 01233 637955
Art Group	Contact	Mrs V Kerry 01227 700843
Footpath Walks	Contact	Mr D Harris 01233 813711
Women's Institute	Contact	Mrs J Bowes 01233 811875
Parent & Toddler Group	Contact	Mrs H Wade 01233 750032
Neighbourhood Watch	Hastingleigh	Mr G Block 01233 750415
	Elmsted	Mr J Argar 01233 750311

@thebowlinn

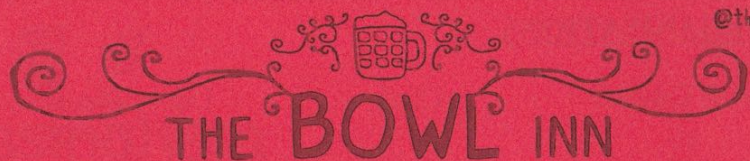

AT HASTINGLEIGH, KENT (nr Wye, off the A28)

CAMRA GOOD BEER GUIDE 2007-2014. ASHFORD, FOLKESTONE & ROMNEY MARSH PUB OF THE YEAR 2012.

MON CLOSED

TUES 5PM - 11PM

WED 5PM - 9PM

THURS 5PM - 9PM

FRI 5PM - 11PM

SAT MIDDAY - LATE

SUN MIDDAY - 9PM



FIND OUT WHICH ALES WE'RE
SERVING NOW BY VISITING
THE PERFECT PINT WEBSITE!



perfectpint.co.uk

A 1740's PUBLIC HOUSE WITH A BEER GARDEN AND A BARN, SERVING THE FINEST LOCAL KENTISH ALES.
PLEASE NOTE: WE'RE CLOSED MONDAYS, OPEN FROM 5PM WEEKDAYS, FOOD ONLY AT WEEKENDS, NO DOGS EXCEPT GUIDE DOGS.

thebowlonline.co.uk

enquiries@thebowlonline.co.uk

01233 750354

Hastingleigh Garage

Motor Vehicle & Agricultural Engineer

MOTs, Welding

Vehicle bodywork repairs & spraying

Hastingleigh Yard, Hastingleigh, Ashford, Kent

Telephone 01233 750413